

Monthly Unsheltered Count

YEARS 2012 - 2020													
	Jan	Feb	Mar	Apr	May	June	July	Aug	Sept	Oct	Nov	Dec	Average
2012 Monthly Totals:	486	485	405	453	513	502	672	623	725	887	636	593	582
2013 Monthly Totals:	531	568	458	509	563	599	571	619	556	541	557	508	548
2014 Monthly Totals:	569	568	634	585	597	662	679	630	614	644	538	555	606
2015 Monthly Totals:	685	744	717	695	629	720	810	657	581	677	765	884	714
2016 Monthly Totals:	672	811	842	843	1148	1156	1162	1386	1140	1130	1170	1415	1073
2017 Monthly Totals:	882	1027	1105	875	892	1156	1100	1335	1275	1091	941	1012	1058
2018 Monthly Totals:	804	862	980	791	904	759	926	964	787	739	799	806	843
2019 Monthly Totals:	898	799	732	776	860	821	961	770	946	847	677	627	809
2020 Monthly Totals:	789	744	529	545	595	721	678	559	719	639	694	622	656
2021 Monthly Totals:	714	667	721	875	1157	1160	1004	1026	799	1026	1124	1253	961

2022													
	Jan	Feb	Mar	Apr**	May	June	July	Aug	Sept	Oct	Nov	Dec	
East Village	678	741	622	655	624	712	598	790	846	713	760	850	716
City Center	213	186	214	275	224	241	234	268	235	284	235	271	240
Columbia	61	71	63	63	47	85	35	56	31	29	33	27	50
Marina	42	18	37	44	10	52	12	44	21	27	44	26	31
Cortez	92	118	36	73	60	51	90	83	77	90	114	107	83
Gaslamp	64	41	70	44	44	50	28	44	62	60	54	67	52
Outside Perimeter	259	270	342	320	315	262	256	324	351	458	466	491	343
2022 Monthly Totals:	1409	1444	1384	1474	1324	1453	1253	1609	1622	1660	1706	1839	1515
***2022 EAST VILLAGE BREAKOUT													
North East EV	50	54	56	57	25	119	72	68	74	104	125	100	75
North West EV	105	95	109	118	107	134	78	128	163	166	117	125	120
South East EV	449	505	401	409	430	369	402	492	531	341	81	527	411
South West EV	74	87	56	71	62	90	46	102	78	102	437	98	109

2023													
	Jan	Feb	Mar	Apr	May	June	July	Aug	Sept	Oct	Nov	Dec	
East Village	794	781	665										747
City Center	270	266	342										293
Columbia	36	48	45										43
Marina	23	25	21										23
Cortez	129	98	100										109
Gaslamp	46	72	64										61
Outside Perimeter	640	520	482										547
2023 Monthly Totals:	1939	1810	1718										1822
*** 2023 EAST VILLAGE BREAKOUT													
North East EV	93	83	344										173
North West EV	144	162	84										130
South East EV	461	441	82										328
South West EV	96	96	147										113

Notes:

The preliminary methodology (shown in yellow) counted two individuals per tent and two individuals per vehicle.

On April 27, 2017, the Clean & Safe program adopted the counting methodology used by the Regional Task Force on the Homeless. Per the methodology (represented above by the dark gray cells), Clean & Safe staff counted 1.75 individuals per visible tent/structure and 1.66 individuals per vehicle that showed clear signs of habitation.

In May 2018, the Regional Task Force on the Homeless updated the methodology for vehicles to 2.03 that shows clear signs of habitation (the methodology of 1.75 individuals per tent/structure remained the same). The Clean & Safe program implemented this methodology on May 31, 2018 (represented in light blue).

In January 2020, the Regional Task Force on the Homeless stopped using methodology for vehicles and structures, however, the Clean & Safe program continues to use the methodology.

* Denotes the months that The Downtown Fellowship of Ministries and Churches collaborated with us on the monthly unsheltered homeless sleep count.

** Denotes the month the Outer Perimeter began inclusion into the overall Unsheltered Homeless Sleep count beginning April 2021

***East Village breakout areas include the following:

North East East Village is the area north of Market Street & east of Park Ave.

North West is the area north of Market Street & west of Park Ave.



South East is the area east of Park Ave. south of Market Street

South West is the area west of Park Ave. south of Market Street



Find

Columbia N
12AM-5AM

Date: 3/30/2023
 Temperature: 52°
 Rain: Yes/No
 Event: Yes/No

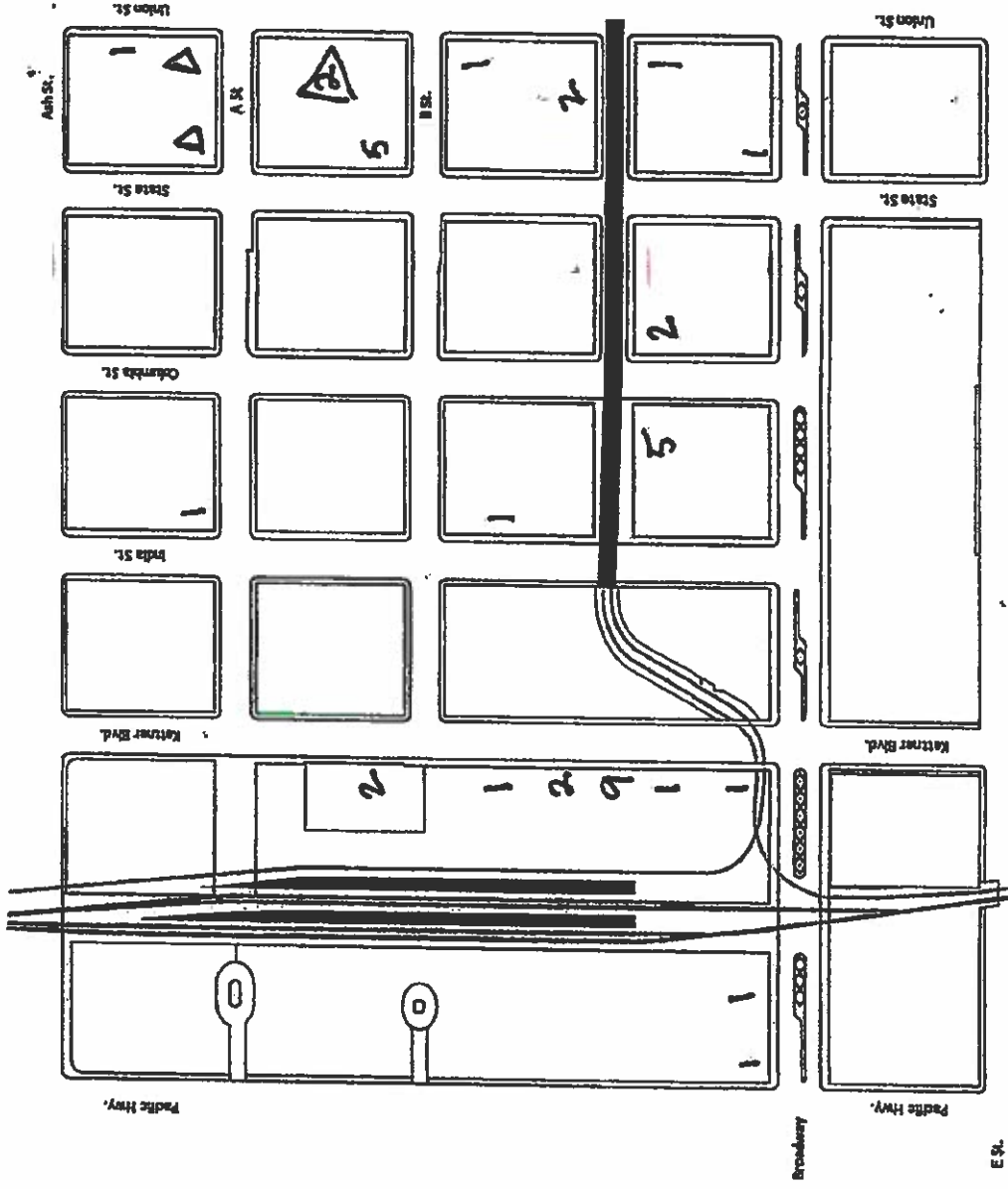
Count Breakdown		Count	Value
		38	38
		6	6
		4	7
Total			45.00



 = 2.03 homeless individuals in vehicles
 = 1.75 homeless individuals in tents/hand-made structures



*Per the methodology, Clean & Safe staff will count 1.75 individuals per visible tent/structure and 2.03 individuals per vehicle that shows clear signs of habitation.

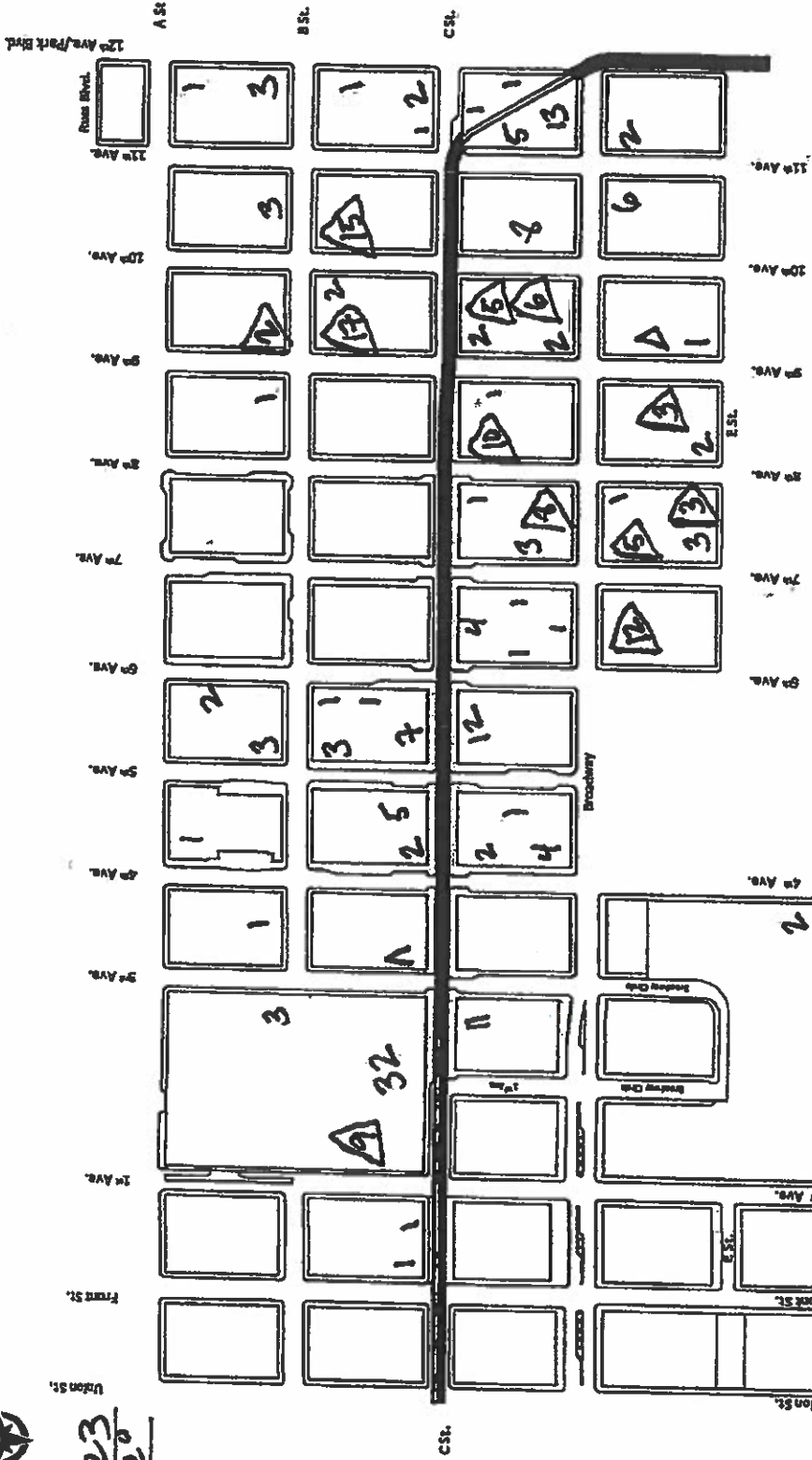

Final

City Center N
12AM-5AM

Date: 3/30/2023
 Temperature: 52.0
 Rain: Yes/No
 Event: Yes/No



Count Breakdown	
Count	Value
	172
	97
	169.75
Total	341.75



 = 2.03 homeless individuals in vehicles
 = 1.75 homeless individuals in tents/ hand-made structures

*Per the methodology, Clean & Safe staff will count 1.75 individuals per visible tent/structure and 2.03 individuals per vehicle that shows clear signs of habitation.

Final

East Village N
12AM-5AM

Date: 3/29/2023
 Temperature: 52°
 Rain: Yes/No
 Event: Yes/No

Count Breakdown		Count	Value
		221	221
		9	18.27
		243	425.25
	Total		664.52

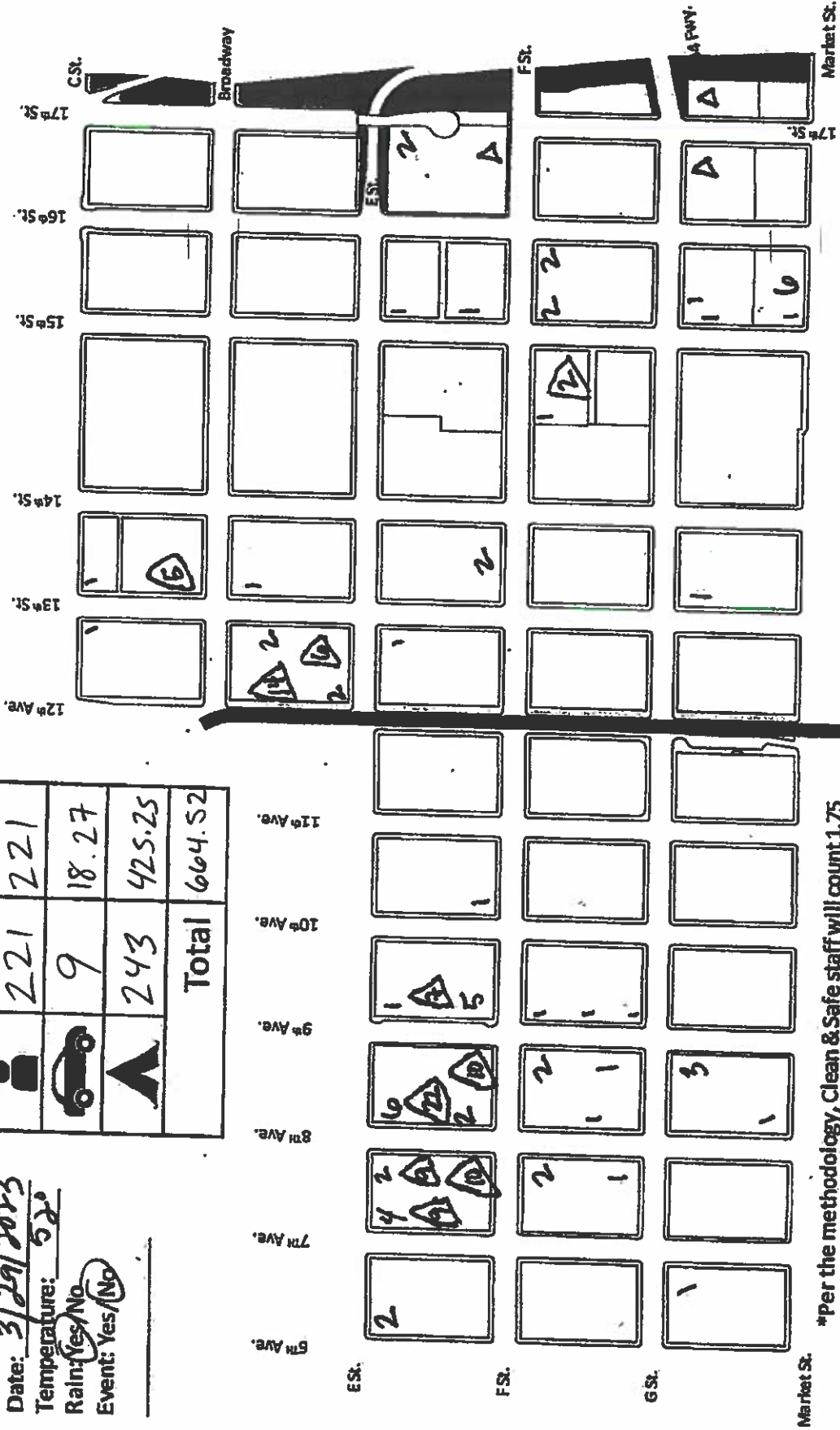

DOWNTOWN
SAN DIEGO
 PARTNERSHIP
 CLEAN & SAFE

*Per the methodology, Clean & Safe staff will count 1.75 individuals per visible tent/structure and 2.03 individuals per vehicle that shows clear signs of habitation.

Final

East Village South 12AM-5AM

Date: 3/29/2013
Temperature: 50
Rain: Yes/No
Event: Yes/No

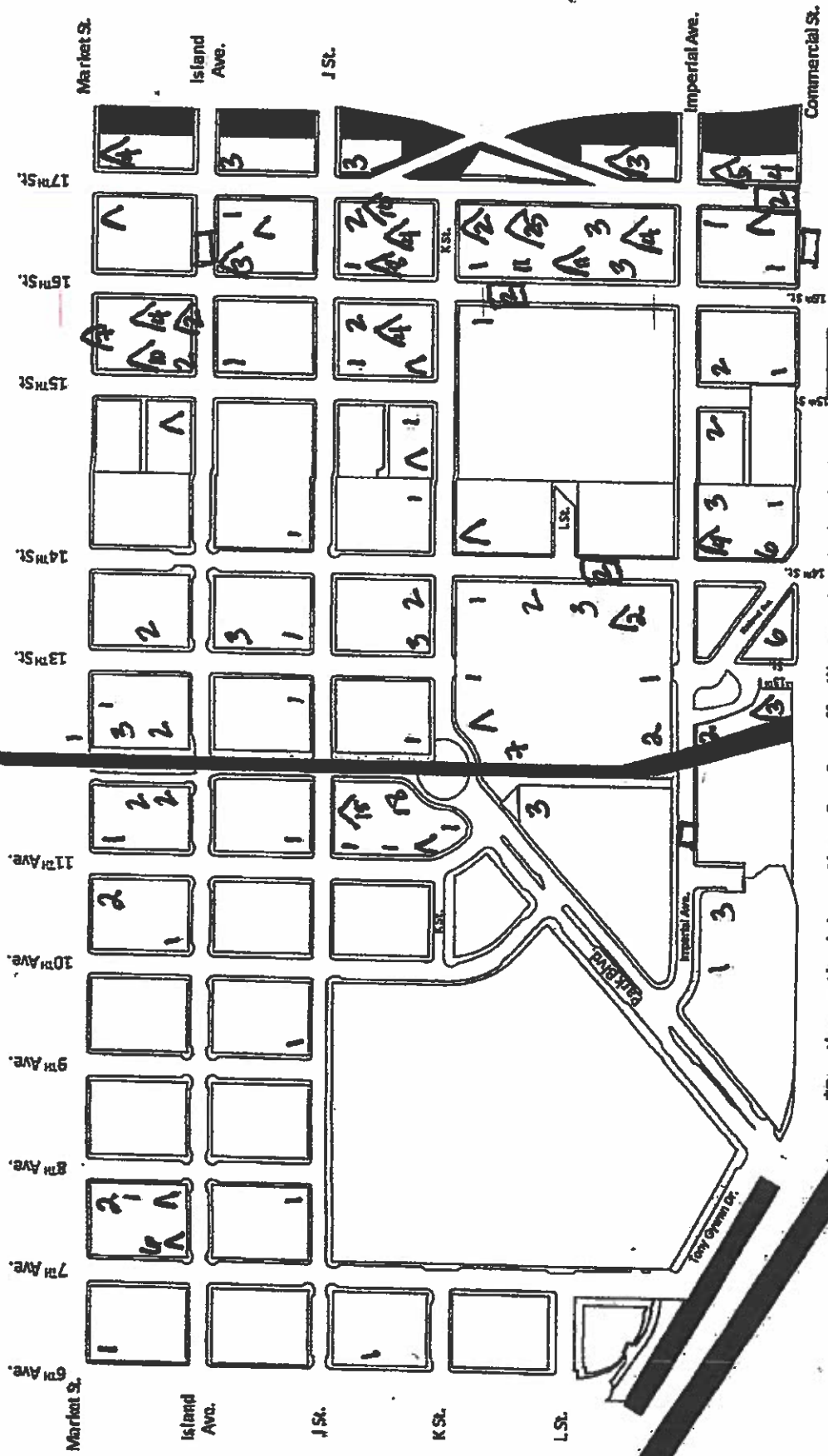

*Per the methodology, Clean & Safe staff will count 1.75 individuals per visible tent/structure and 2.03 individuals per vehicle that shows clear signs of habitation.

□ = 2.03 homeless individuals in vehicles
 △ = 1.75 homeless individuals in tents/hand-made structures

DOWNTOWN
SAN DIEGO
 PARTNERSHIP
 CLEAN & SAFE

Final



Gaslamp N
12AM-5AM

Date: 3/30/2023

Temperature: 52°

Rain/Yes/No

Event: Yes/No

Count Breakdown	
Count	Value
 64	64
 6	6
 6	6
Total	64.00

 = 2.03 homeless individuals in vehicles

 = 1.75 homeless individuals in tents/hand-made structures

*Per the methodology, Clean & Safe staff will count 1.75 individuals per visible tent/structure and 2.03 individuals per vehicle that shows clear signs of habitation.

DOWNTOWN
SAN DIEGO
 PARTNERSHIP
 CLEAN & SAFE

Harbor Dr.

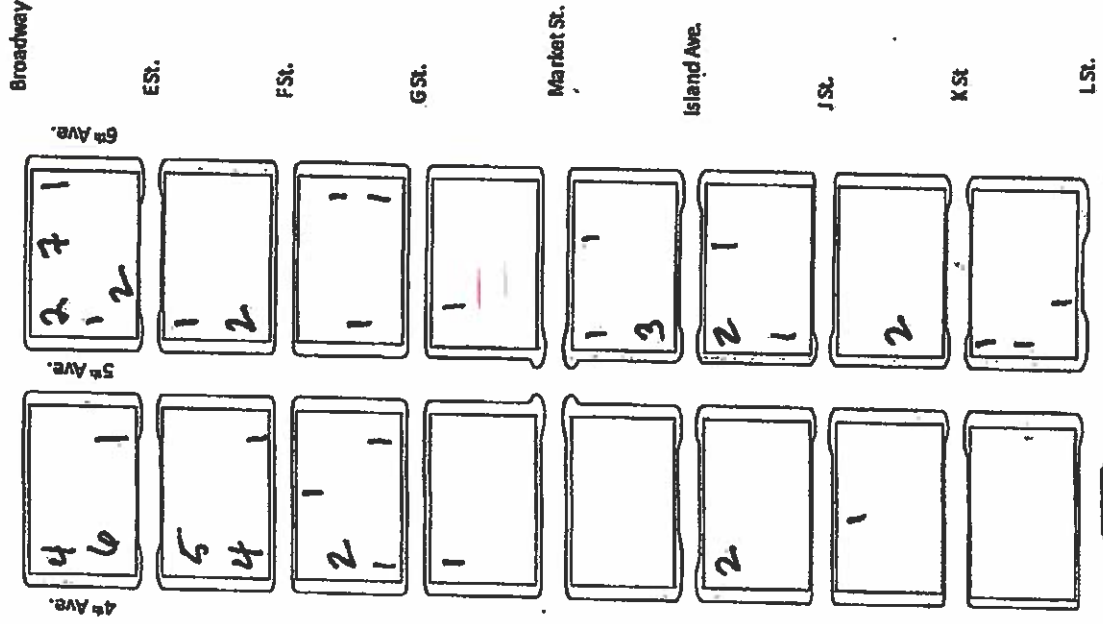

Find N

Marina
12AM-5AM

Date: 3/30/2023
 Temperature: 12°
 Rain: (Yes/No)
 Event: Yes/No

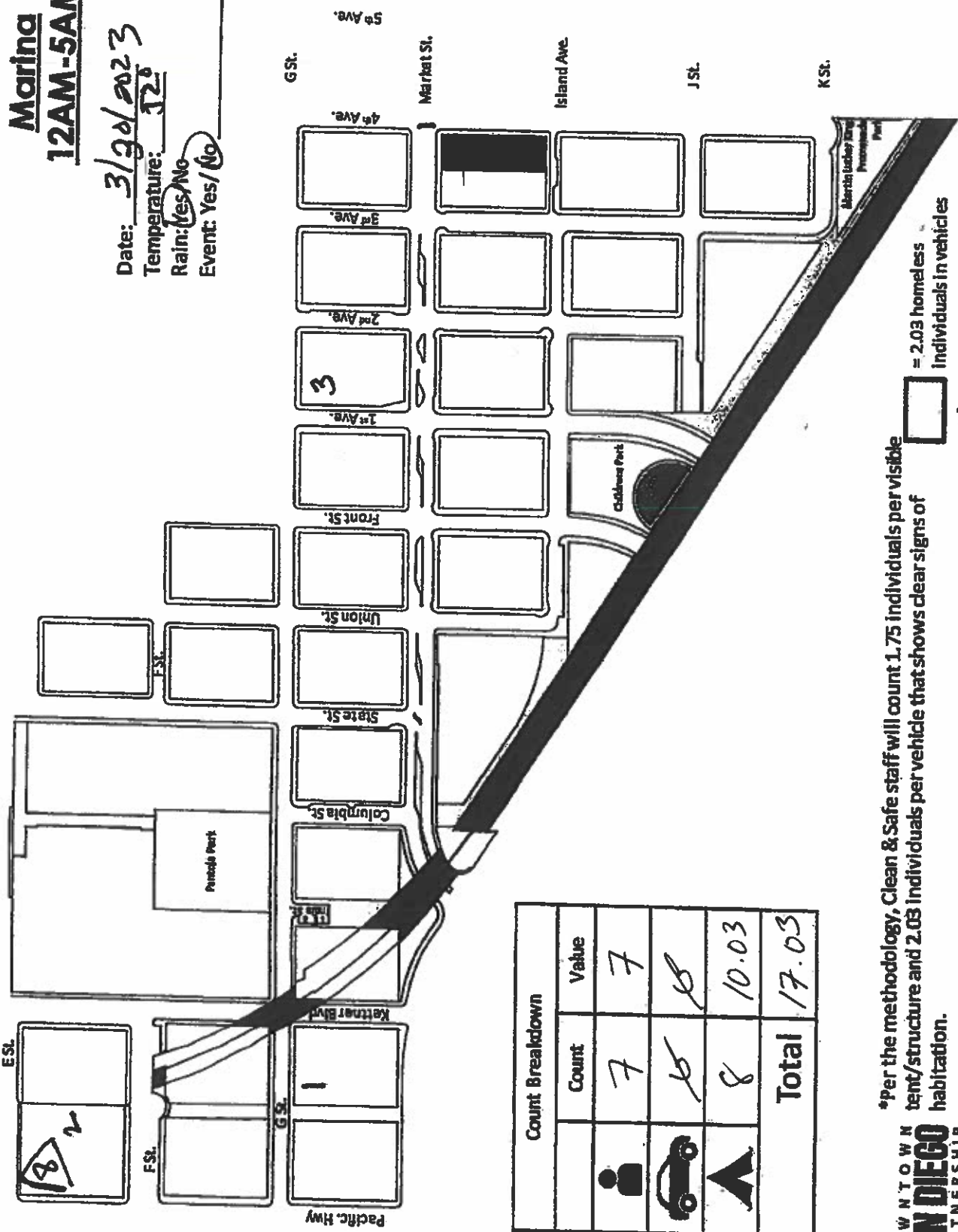

Count Breakdown	
Count	Value
7	7
6	6
8	10.03
Total	17.03

□ = 2.03 homeless individuals in vehicles
 △ = 1.75 homeless individuals in tents/hand-made structures

*Per the methodology, Clean & Safe staff will count 1.75 individuals per visible tent/structure and 2.03 individuals per vehicle that shows clear signs of habitation.

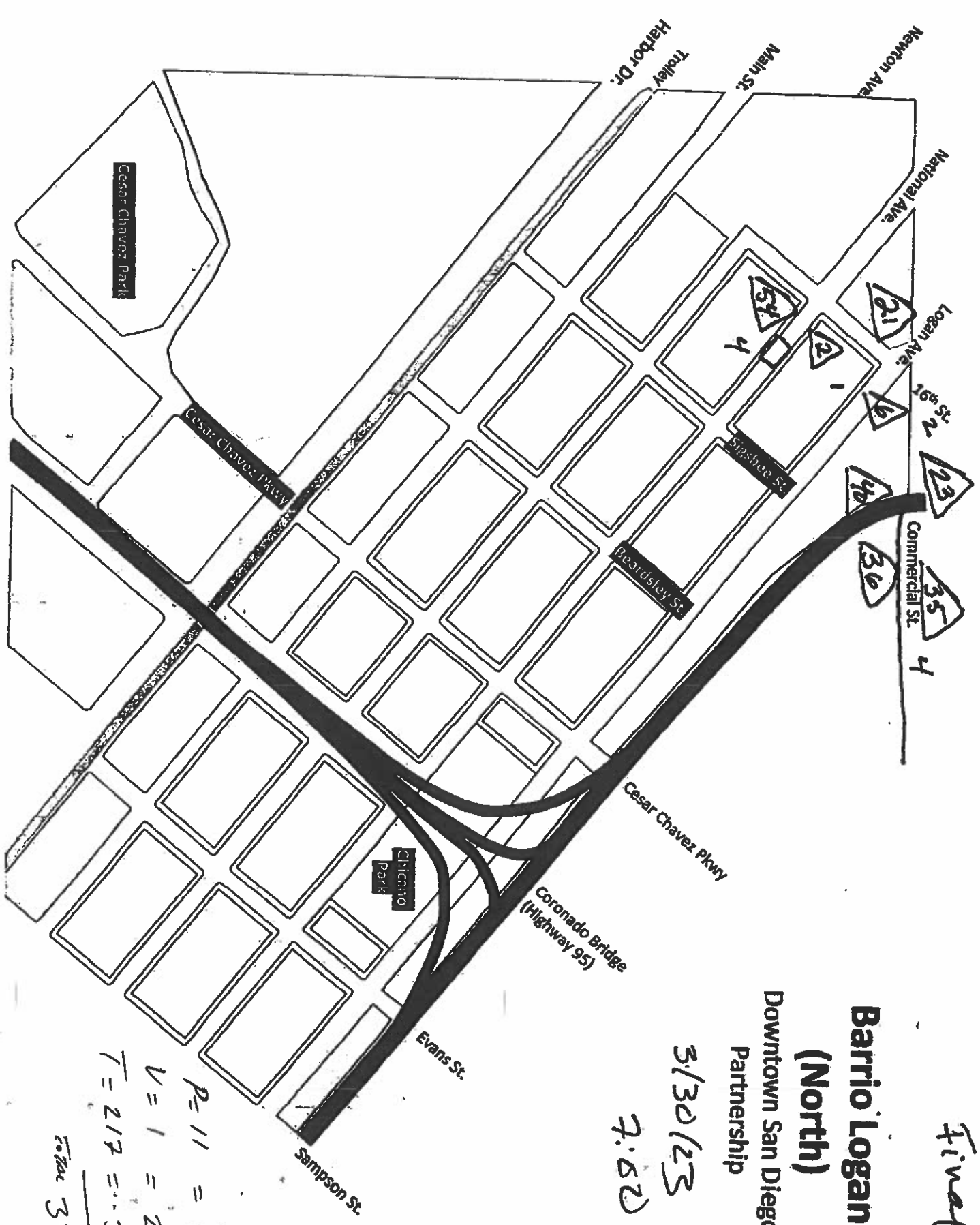

Final

**Barrio Logan
(North)**

Downtown San Diego
Partnership

3/30/23

7:50

$P = 11 = 11$
 $V = 1 = 2.03$
 $T = 217 = 379.75$

 Total 392.78

Final

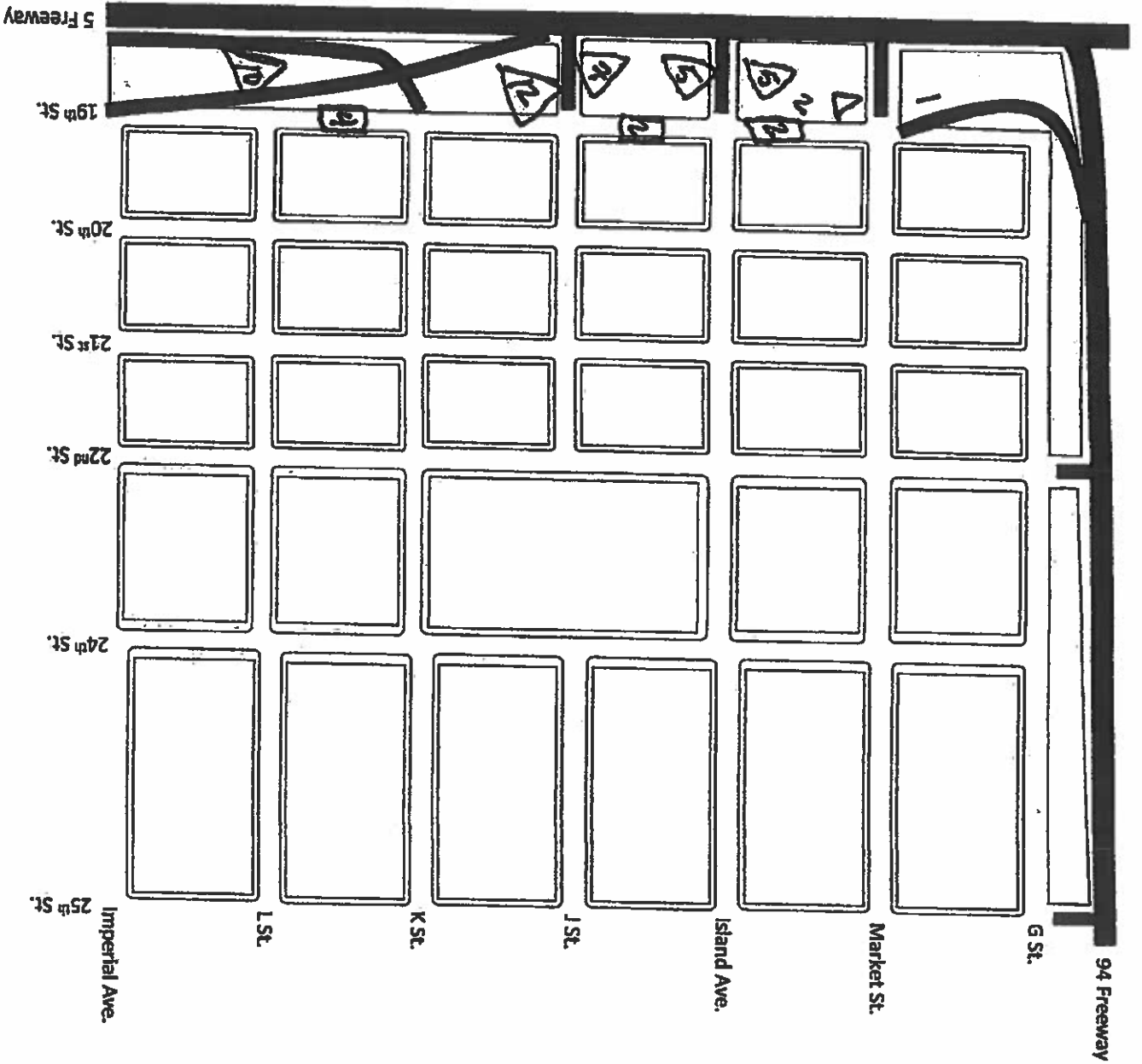

Sherman Heights
Downtown San Diego
Partnership

3/30/23 7:15

$$P = 3 = 3$$

$$V = 8 = 16.24$$

$$T = 40 = 70$$

Total 82.24

Final

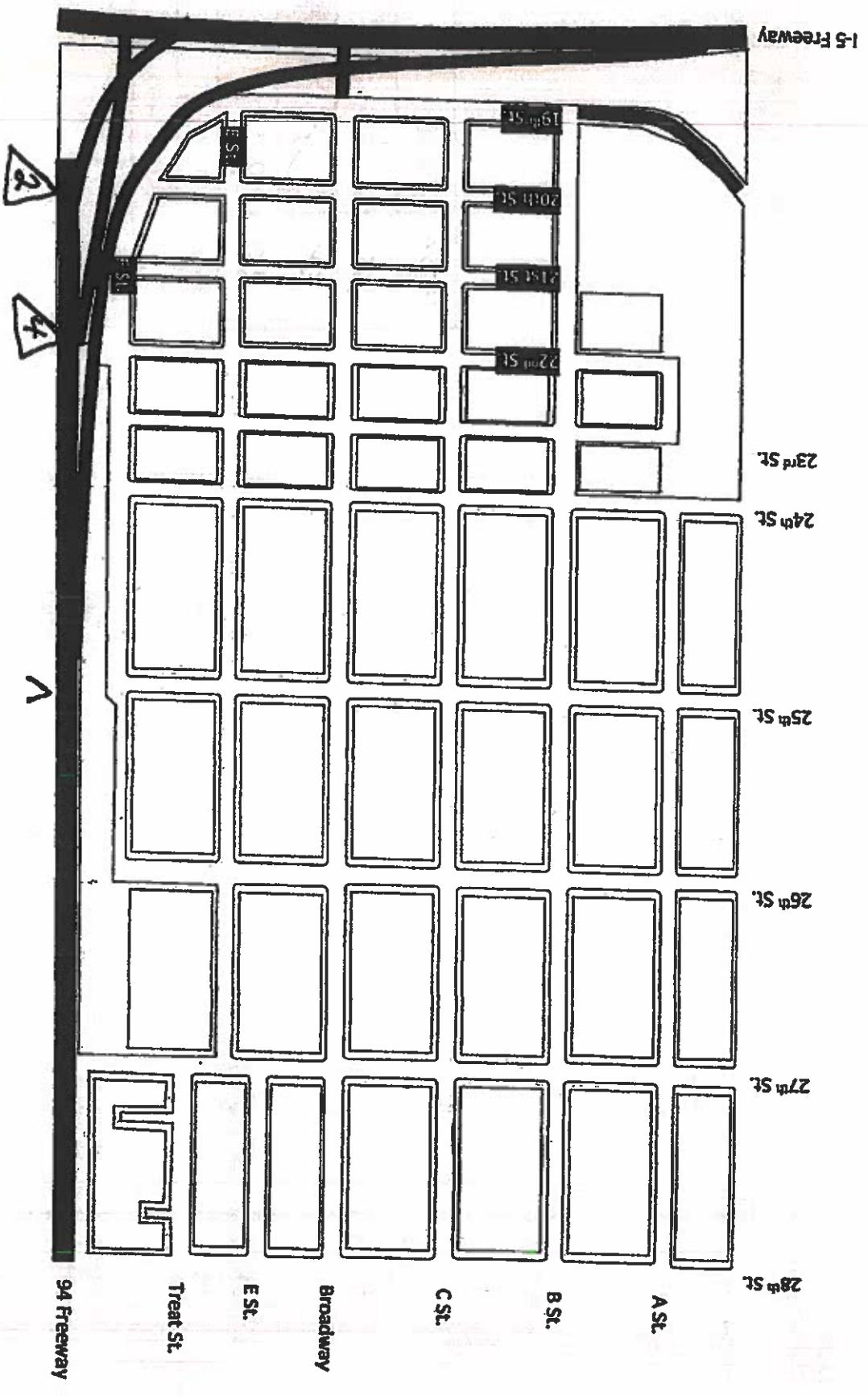

Golden Hill (West)

Downtown San Diego Partnership

3/30/23 7:00

$$\begin{aligned}
 P &= 8 = 8 \\
 V &= 8 = 8 \\
 T &= 7 = 12.25
 \end{aligned}$$

$$\frac{8 \text{ Mar}}{12.25}$$