



# Monthly Homeless Count

## Regional Taskforce on the Homeless Methodology

2012 - 2014													
	Jan	Feb	Mar	Apr	May	June	July	Aug	Sept	Oct	Nov	Dec	Average
2012 Monthly Totals:	486	485	405	453	513	502	672	623	725	887	636	593	582
2013 Monthly Totals:	531	568	458	509	563	599	571	619	556	541	557	508	548
2014 Monthly Totals:	569	568	634	585	597	662	679	630	614	644	538	555	606
2015 Monthly Totals:	685	744	717	695	629	720	810	657	581	677	765	884	714
2016 Monthly Totals:	672	811	842	843	1148	1156	1162	1386	1140	1130	1170	1415	1073
2017													
	Jan	*Feb	*Mar	*Apr	*May	*June	July	*Aug	*Sept	*Oct	*Nov	*Dec	Average
East Village	629	663	783	598	548	781	734	885	768	649	580	663	690
Core	117	168	169	121	145	173	158	169	195	174	162	147	158
Columbia	36	35	20	46	59	41	47	70	61	56	49	46	47
Marina	26	62	56	41	42	50	49	74	72	79	50	49	54
Cortez	32	42	37	26	49	57	64	71	95	78	58	53	55
Gaslamp	42	57	40	43	49	54	48	66	85	56	42	55	53
Monthly Totals:	882	1027	1105	875	892	1156	1100	1335	1275	1091	941	1012	1058
**EAST VILLAGE BREAKOUT													
North East EV	110	103	69	42	67	78	83	43	118	52	66	56.82	74
North West EV	54	81	73	63	71	96	117	116	89	74	91	127.5	88
South East EV	450	457	589	470	383	585	516	688	523	458	398	428.9	495
South West EV	15	22	52	23	27	22	18	38	38	35	25	49.5	30
Outreach Area	78	93	93	70	101	132	98	124	176	144	135	116	113
2018													
	*Jan	*Feb	*Mar	Apr	May	June	July	Aug	Sept	Oct	Nov	Dec	Average
East Village	495	474	594	502									516
Core	123	156	128	111									130
Columbia	50	58	61	46									54
Marina	31	34	32	37									33
Cortez	61	56	72	44									58
Gaslamp	44	84	93	51									68
Monthly Totals:	803	863	980	791									859
**EAST VILLAGE BREAKOUT													
North East EV	58	68	86	75									72
North West EV	67	45	89	92									73
South East EV	334	361	361	294									338
South West EV	36	30	58	41									41
Outreach Area	112	133	115	60									105

**Notes:**

- On April 27, 2017, the Clean & Safe program adopted the counting methodology used by the Regional Task Force on the Homeless. Per the methodology, represented above by the dark green cells, Clean & Safe staff counts **1.75 individuals per visible tent/structure and 1.66 individuals per vehicle that shows clear signs of habitation**. The former methodology (shown in yellow) counted two individuals per tent and two individuals per vehicle.

- The **outreach area** outlined above refers to Connections Housing; an organization that provides interim and permanent housing for homeless who are referred from the target area of First Street to 10th Ave. and Cedar to Broadway. The outreach area data reflects the number of homeless found sleeping in this target area. It does not reflect the number of residents living at Connections Housing. Connections Housing opened in March of 2013. Data gathered prior to their opening is used for benchmarking purposes.

\*Denotes months when the Downtown Fellowship of Ministries and Churches collaborated with the Clean & Safe program on the monthly homeless sleep count.

\*\*East Village breakout areas include the following:

North East East Village refers to the area north of Market Street & east of Park Ave.

North West East Village refers to the area north of Market Street & west of Park Ave.

South East East Village refers to the area east of Park Ave. south of Market Street

South West East Village refers to the area west of Park Ave. south of Market Street

Downtown Fellowship of Churches & Ministries

Print Name: \_\_\_\_\_

Signature: \_\_\_\_\_

Date: 01/25/18

Weather: Clear Other: \_\_\_\_\_

COUNT	VALUE
P 370	370
V 14	23.24
T 62	108.50
<b>TOTAL</b>	<b>501.74</b>

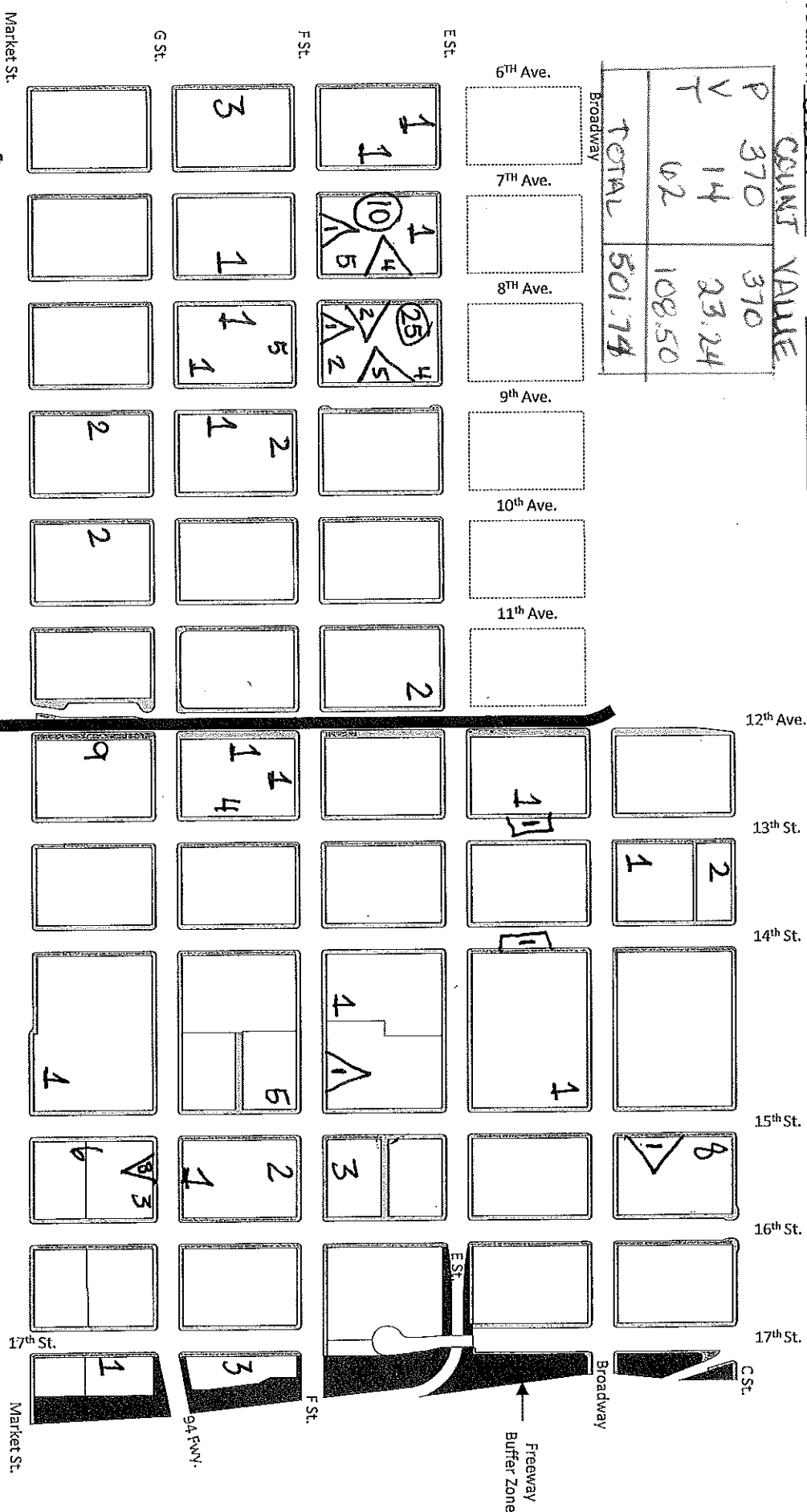

\*The Clean & Safe Program homeless count tabulates 1.75 individuals per visible tent and 1.66 individuals per vehicle that show clear signs of homeless habitation.

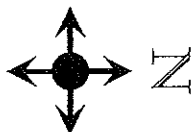

**East Village**

**12AM-5AM**

Freeway Buffer Zone

Trolley Line

Market St.

94 FWN

Downtown Fellowship of Churches & Ministries

Print Name: \_\_\_\_\_

Signature: \_\_\_\_\_



Date: 04/25/18 Clear

Weather: \_\_\_\_\_ Other: \_\_\_\_\_

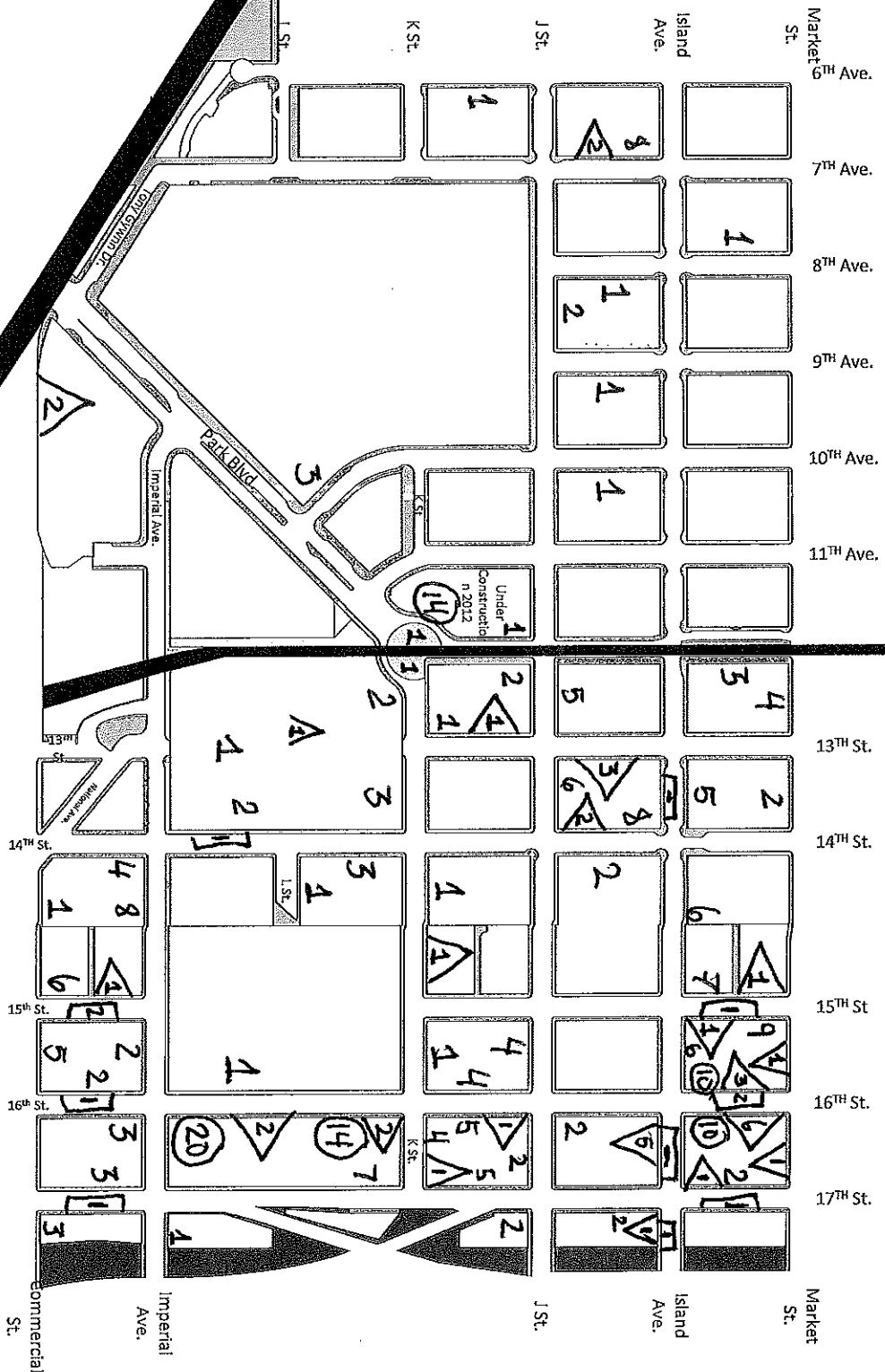
**East Village South**



\*The Clean & Safe Program homeless count tabulates 1.75 individuals per visible tent and 1.66 individuals per vehicle that show clear signs of homeless habitation.

-  = 1.66 homeless individuals in vehicles
-  = 1.75 homeless individuals in tents/hand-made structures



Downtown Fellowship of Churches & Ministries

Print Name: \_\_\_\_\_

Signature: \_\_\_\_\_

Date: 04/25/18

Weather: Clear Other: \_\_\_\_\_

		COUNT VALUE	
P	106	106	
V	0	0	
T	3	5.25	
		111.25	

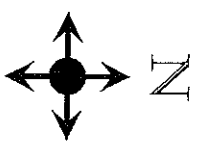

**Core**  
**12AM-5AM**

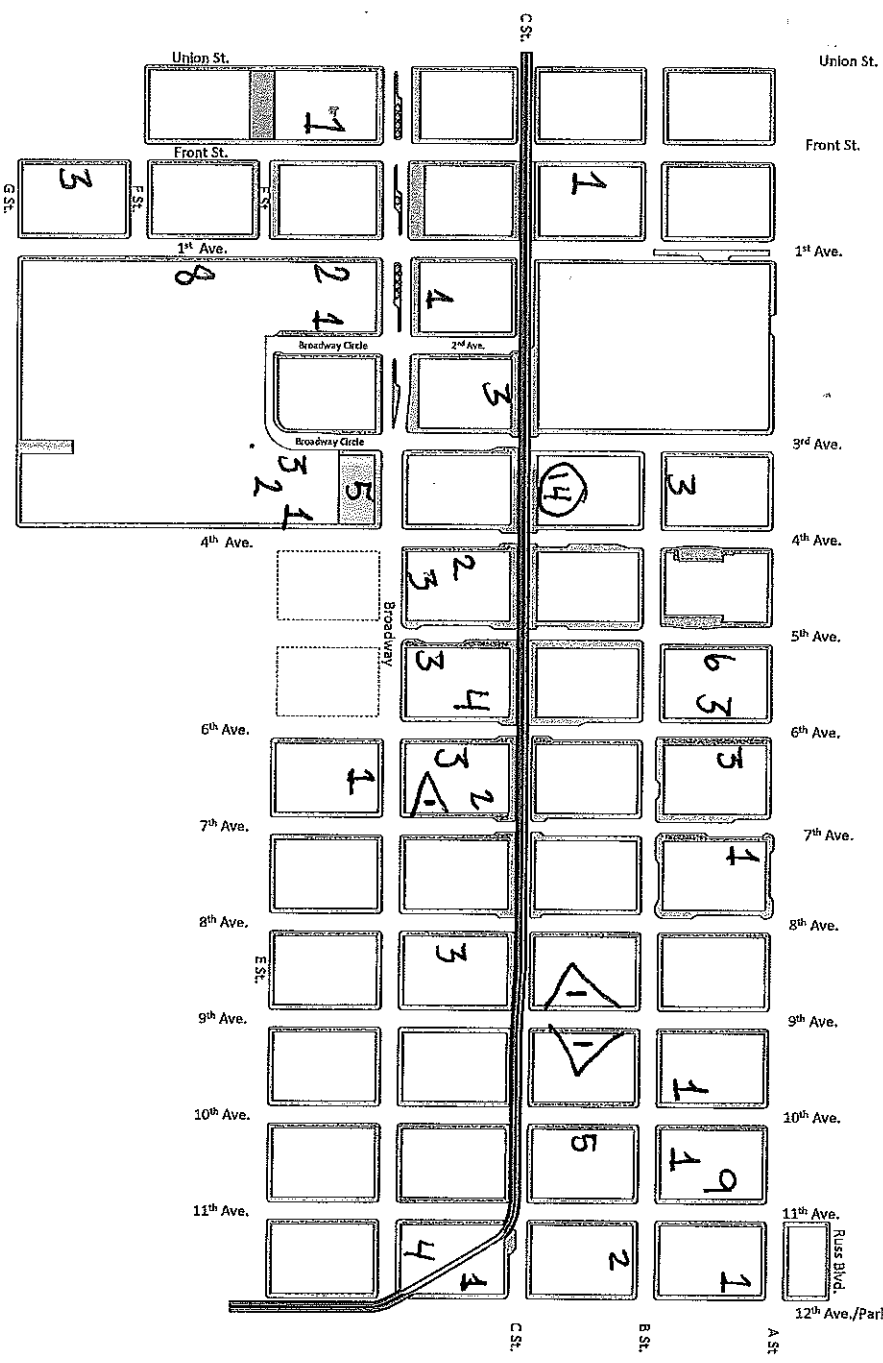

= 1.66 homeless individuals in vehicles



= 1.75 homeless individuals in tents/ hand-made structures

\*The Clean & Safe Program homeless count tabulates 1.75 individuals per visible tent and 1.66 individuals per vehicle that show clear signs of homeless habitation.



Downtown Fellowship of Churches & Ministries

Print Name: \_\_\_\_\_

Signature: \_\_\_\_\_

Date: 04/25/18

Weather: Clear Other: \_\_\_\_\_

	COUNT	VALUE
P	37	37
V	0	0
T	5	8.75
TOTAL		45.75

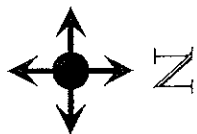
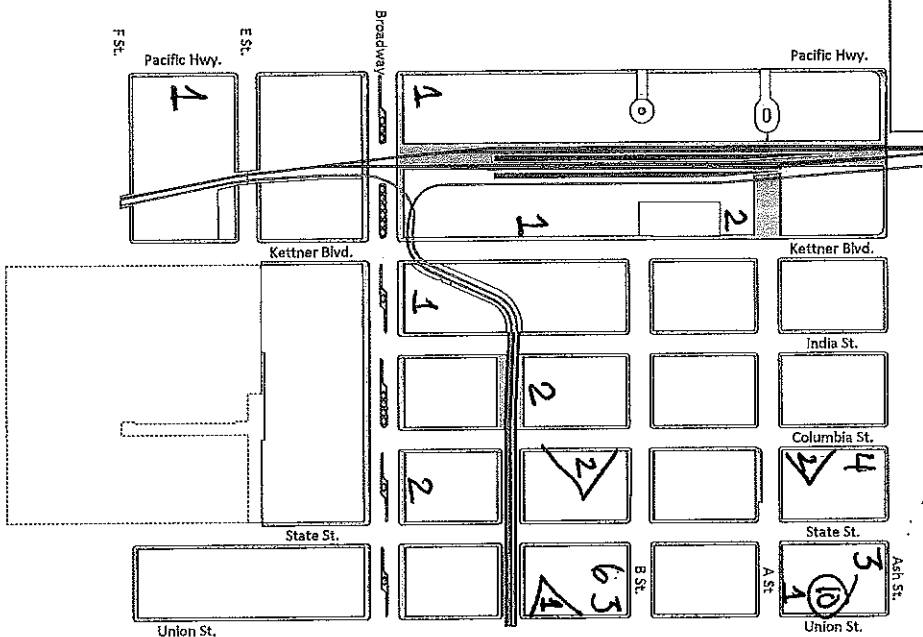

**Columbia**  
**12AM-5AM**



= 1.66 homeless individuals in vehicles



= 1.75 homeless individuals in tents/hand-made structures

\*The Clean & Safe Program homeless count tabulates 1.75 individuals per visible tent and 1.66 individuals per vehicle that show clear signs of homeless habitation.



**Marina**  
**12AM-5AM**

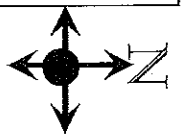

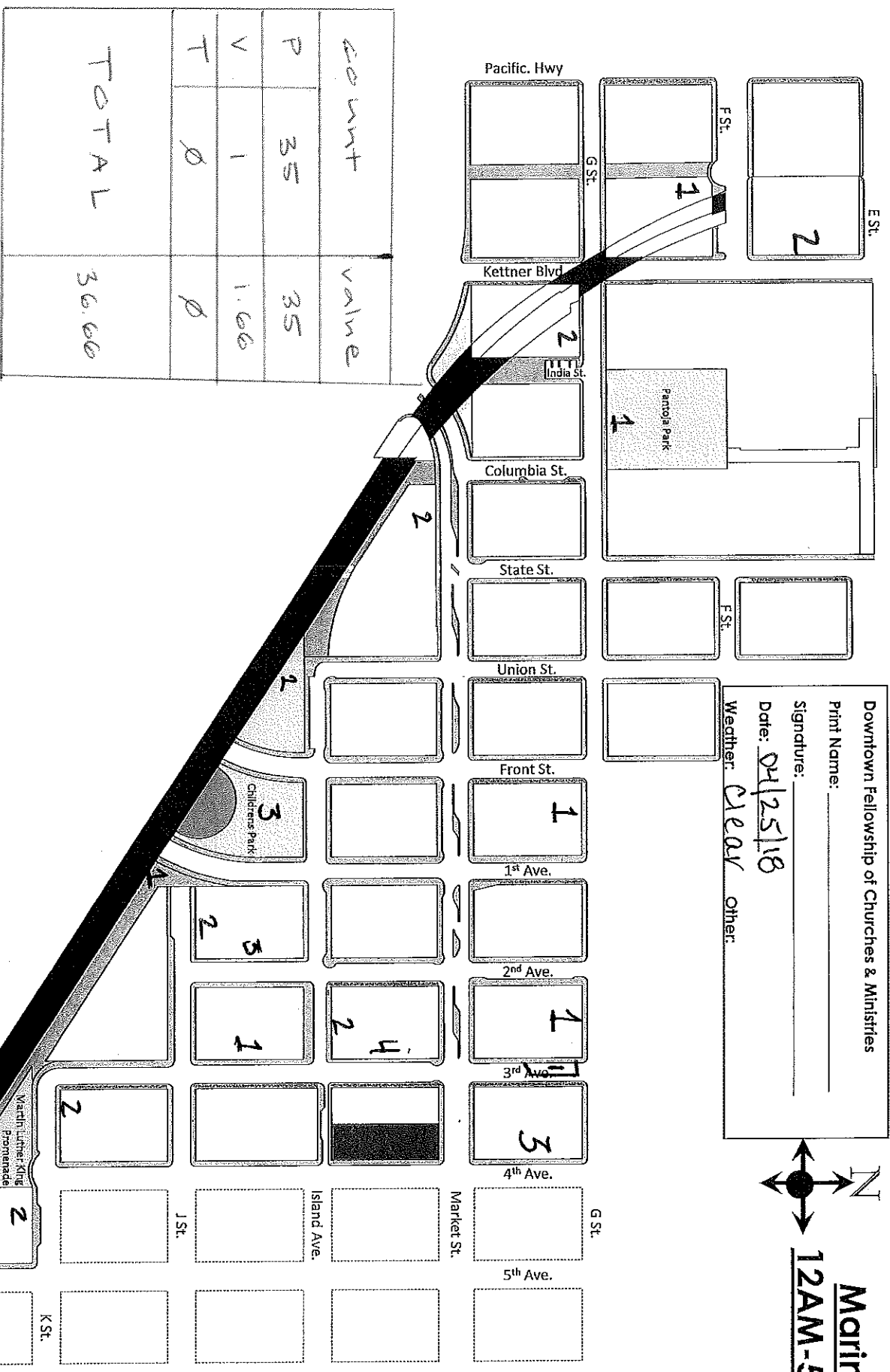

Downtown Fellowship of Churches & Ministries  
 Print Name: \_\_\_\_\_  
 Signature: \_\_\_\_\_  
 Date: 04/25/18  
 Weather: Clear other: \_\_\_\_\_



count	value
P 35	35
V 1	1.66
T 0	0
<b>TOTAL</b>	<b>36.66</b>

\*The Clean & Safe Program homeless count tabulates 1.75 individuals per visible tent and 1.66 individuals per vehicle that show clear signs of homeless habitation.

-  = 1.66 homeless individuals in vehicles
-  = 1.75 homeless individuals in tents/hand-made structures



**Cortez**  
**12AM-5AM**



**Downtown Fellowship of Churches & Ministries**

Date: 04/25/18

Name: \_\_\_\_\_

Signature: \_\_\_\_\_

Temperature: Clear

Rain: Yes/No

Count Breakdown	
Count	Value
	39
	1
	2
<b>Total</b>	<b>44.16</b>

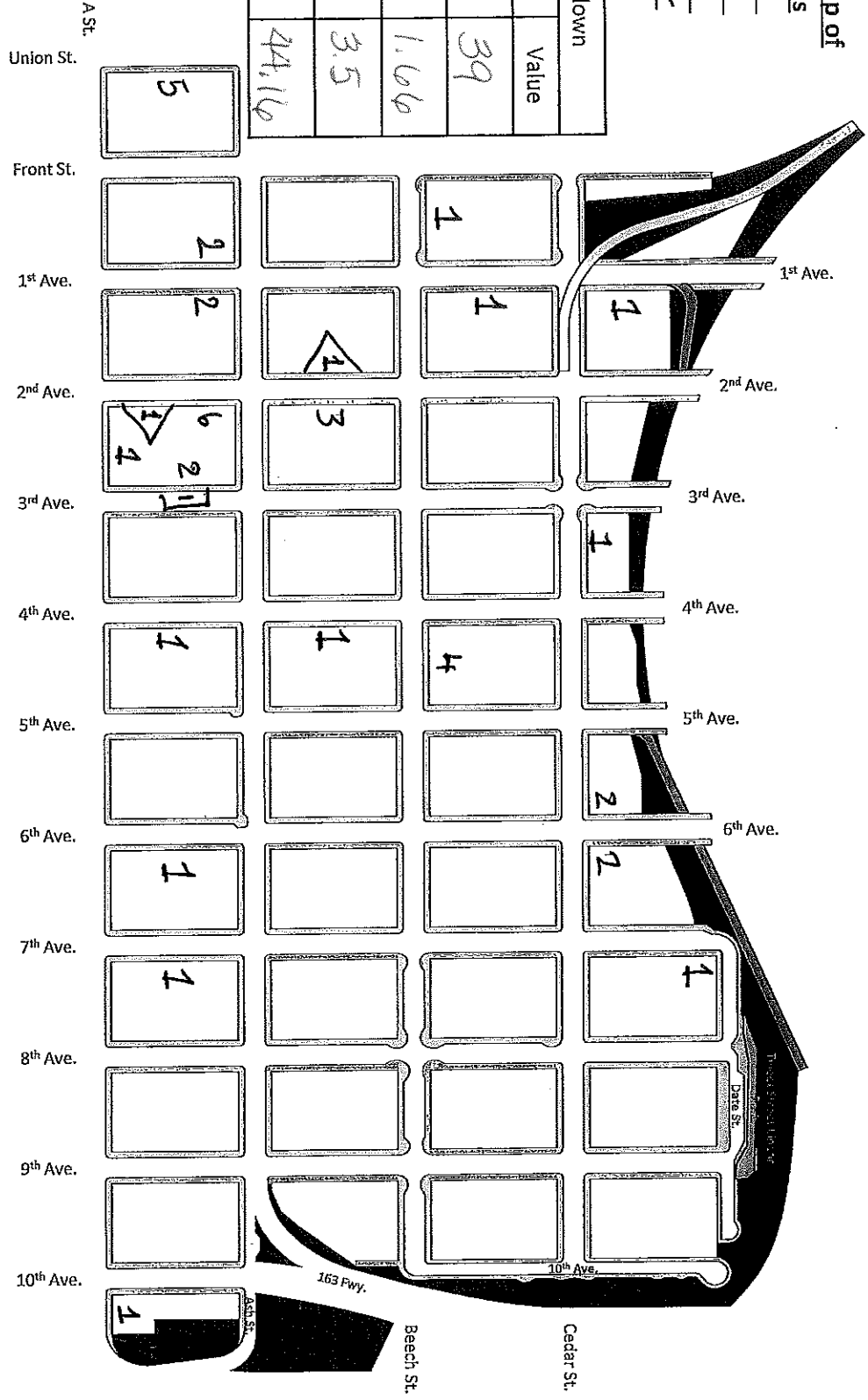

\*On April 27, 2017, the Clean & Safe program adopted the methodology used by the Regional Task Force on the Homeless to count homeless individuals. Per the methodology, Clean & Safe staff will count 1.75 individuals per visible tent/structure and 1.66 individuals per vehicle that shows clear signs of habitation.

= 1.66 homeless individuals in vehicles  
 = 1.75 homeless individuals in tents/hand-made structures



**Downtown Fellowship of Churches & Ministries**

Print Name: \_\_\_\_\_

Signature: \_\_\_\_\_

Date: 04/25/18

Weather: Clear Other: \_\_\_\_\_



COUNT	VALUE
D 51	51
V 0	0
T 0	0
<b>TOTAL</b>	<b>51</b>

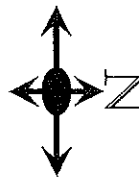

\*The Clean & Safe Program homeless count tabulates 1.75 individuals per visible tent and 1.66 individuals per vehicle that show clear signs of homeless habitation.

**Gaslamp**  
**12AM-5AM**



-  = 1.66 homeless individuals in vehicles
-  = 1.75 homeless individuals in tents/hand-made structures

